

固定倍单筒视频显微系列  
Fixed Magnification Monocular Video Micro Series

品种最齐全  
Complete Variety

倍率固定  
Fixed Mag.

接受定制  
Accept Customization



MTD series

- 拥有中国品种最齐全的单筒视频显微物镜产品库
- 包括单倍率视频光学系统，单筒斜筒对刀显微镜，双倍率视频光学系统，MTDP无穷远镜头单筒视频光学系统等系列
- 有不同放大倍率、各种工作距离、同轴照明、光路90°，180°转折、双倍率等近二百种规格型号
- 用于电子设备、半导体检测、锡点检测、印刷贴纸检测、晶片及液晶显示检测以及类似用途
- 常规设计的接口均为C接口（定位面至靶面的距离为17.5mm），如需要CS接口（定位面至靶面的距离为12.5mm），均可以定制
- 访问公司网站以获得更多的定制产品信息
- ◆ Most complete variety of monocular video microscope objectives in China
- ◆ Single Magnification Video Optical Systems, Lathe tool--setting Inclined Eyetube Microscope, Double Magnification Video Optical Systems, MTDP Infinity Monocular Video Optical Systems
- ◆ Over 200 models which configure different magnification, working distance, coaxial illuminator, optical path turn 90°, 180° double magnification and etc.
- ◆ Applied for inspection and similar purpose on electric equipments, semiconductor, tin, printed stickers, wafer, LCD display.
- ◆ standard CS mount (the distance from the positioning surface to the target surface is 12.5mm), if C mount is needed (the distance is 17.5mm), it can be customized.
- ◆ Visit our website to get more customized product information.

产品命名规则 Name Rule

MTD   20 C-185 S A

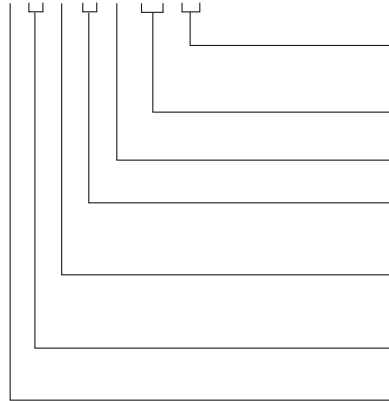

表示光路180°转向 (RA为光路90°转向，没有光路转折不含此字母)  
SA: Means light path 180° transition ( RA means light path 90° transition)

表示物镜工作距离 (mm) / Objective working distance(mm)

表示同轴照明 (不含同轴照明则没有“C”字母/ C: Means coaxial illumination)

表示物镜放大倍率 (此数字乘以0.1即为其倍率)  
Means objective mag. ( the number multiply 0.1 gain its mag.)

M表示普及型, Y表示远心镜头, P表示无穷远  
M: Means popular series; Y: Means telecentric lens series; P: Means infinity farness series

表示固定倍单筒/ Means fixed magnification monocular

表示迈特光学/ Means Guilin Microtech Optical Instrument Co., LTD.

※本系列产品已获得国家专利授权，受相关国家法律法规保护。专利号：ZL 2011 2 0165124.7  
This series have obtained national patents, and protected by related national laws and regulations. Patent number: ZL 2011 2 0165124.7

品种最齐全  
Complete Variety

倍率固定  
Fixed Mag.

接受定制  
Accept Customization

远心镜头是将孔径光阑放置在光学系统的像方焦平面上，当孔径光阑放在像方焦平面上时，即使物距发生改变，像距也发生改变，但像高并没有发生改变，即测得的物体尺寸不会变化。  
远心镜头用于工业精密测量，畸变极小。高性能的可以达到无畸变。

Telecentric Lens is that placed aperture diaphragm on image space focal plane of optical system. When aperture diaphragm on image space focal plane, even object distance changes and image distance changes, image height doesn't changes, then object size of measure will not change.

Telecentric Lens is applied in industry precision measurement. Distortion is very small. High-powered one can have no distortion.

MTD series

MTDY08-65

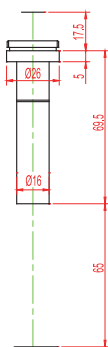

MTDY08C-65

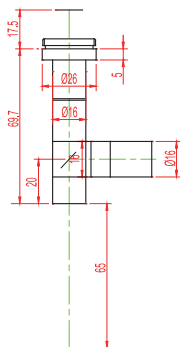

MTDY10-65

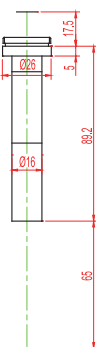

MTDY10C-65

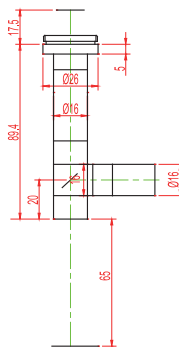

MTDY20-65

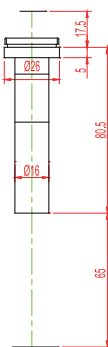

MTDY20C-65

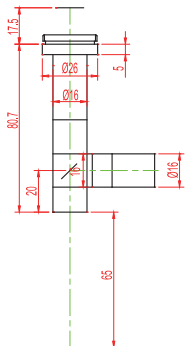

MTDY30-65

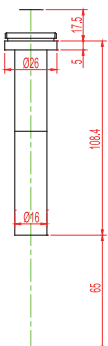

MTDY30C-65

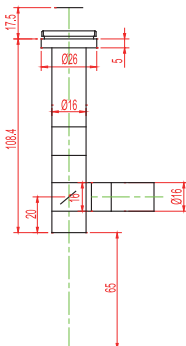

MTDY40-65

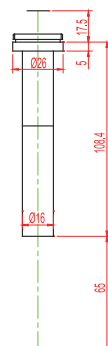

MTDY40C-65

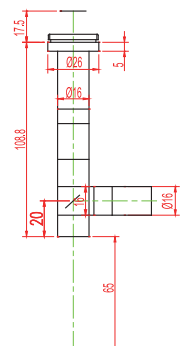

型号 Model	物镜倍数 Objective Mag.	工作距离 WD(mm)	总放大倍数 / Total Mag.		视场 FOV(mm)	数值孔径 NA	分辨率 Resolution ( $\mu\text{m}$ )	景深 DOF (mm)	失真 Distortion
			1/3"、9"	1/3"、17"					
MTDY08-65	0.8X	65	30.5X	57.6X	6X4.5	0.03	11.2	1.67	0.09%
MTDY08C-65									
MTDY10-65	1X	65	38.1X	72X	4.8X3.6	0.032	10.5	1.25	0.13%
MTDY10C-65									
MTDY20-65	2X	65	76.2X	43.9X	2.4X1.8	0.05	6.7	0.4	0.30%
MTDY20C-65									
MTDY30-65	3X	65	114.3X	215.9X	1.6X1.2	0.06	5.6	0.22	0.22%
MTDY30C-65									
MTDY40-65	4X	65	152.4X	287.9X	1.2X0.9	0.039	8.6	0.26	0.24%
MTDY40C-65									

**MTDY** 固定倍远心镜头视频显微系列  
Fixed Mag. Telecentric Lens Video Micro Series

品种最齐全  
Complete Variety

倍率固定  
Fixed Mag.

接受定制  
Accept Customization

MTDY05-115

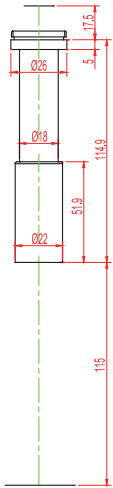

MTDY05C-115

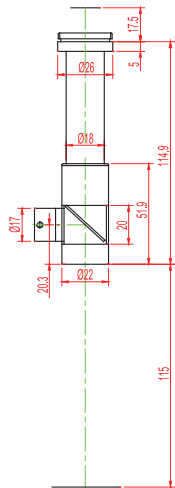

MTDY08-115

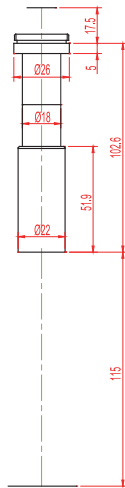

MTDY08C-115

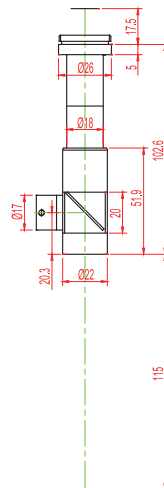

MTDY10-115

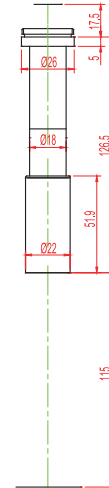

MTDY10C-115

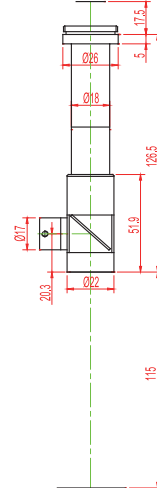

MTDY20-115

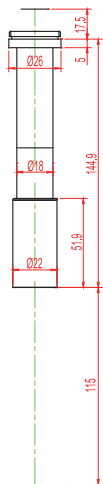

MTDY20C-115

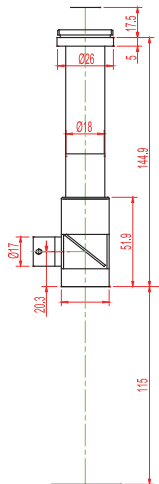

MTDY30-115

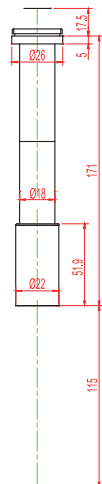

MTDY30C-115

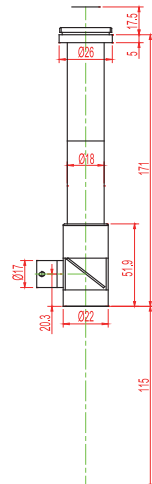

MTDY40-115

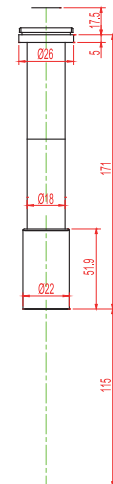

MTDY40C-115

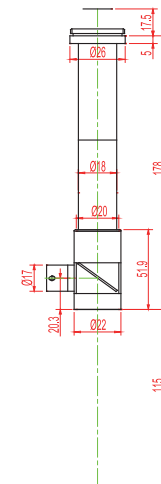

MTD series

型号 Model	物镜倍数 Objective Mag.	工作距离 WD(mm)	总放大倍数 / Total Mag.		视场 FOV(mm)	数值孔径 NA	分辨率 Resolution ( $\mu\text{m}$ )	景深 DOF (mm)	失真 Distortion
			1/3"、9"	1/3"、17"					
MTDY05-115	0.5X	115	19.1X	36X	9.6X7.2	0.02	16.8	4	0.10%
MTDY05C-115									
MTDY08-115	0.8X	115	30.5X	57.6X	6X4.5	0.03	11.2	1.67	0.60%
MTDY08C-115									
MTDY10-115	1X	115	38.1X	72X	4.8X3.6	0.032	10.5	1.25	0.30%
MTDY10C-115									
MTDY20-115	2X	115	76.2X	143.9X	2.4X1.8	0.04	8.4	0.5	0.17%
MTDY20C-115									
MTDY30-115	3X	115	114.3X	215.9X	1.6X1.2	0.05	6.7	0.266	0.17%
MTDY30C-115									
MTDY40-115	4X	115	152.4X	287.9X	1.2X0.9	0.053	6.3	0.188	0.16%
MTDY40C-115									